

ANSI B 16.11
ANSI B1.20.1



Stainless steel and carbon steel



RACCORDI FILETTATI | THREADED FITTINGS

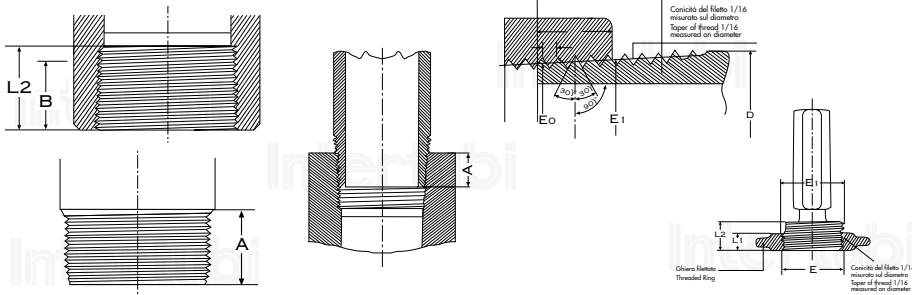

LUNGHEZZA DEL FILETTO

ANSI B16.11

LENGTH OF THREAD

ANSI B16.11

FILETTATURA CONICA PER TUBI (NPT)

ANSI B 1.20.1 O API STD 5 B

STANDARD TAPER PIPE THREAD (NPT)

ANSI B 1.20.1 O API STD 5 B

Diametro nominale Nominal pipe size	Filetto interno - Internal thread				Filetto esterno - External thread	
	B min.		L2 min.		A min.	
	mm	inches	mm	inches	mm	inches
1/8"	6.5	0.25	6.5	0.2639	9.5	0.38
1/4"	8.0	0.32	10.0	0.4018	11.0	0.44
3/8"	9.0	0.36	10.5	0.4078	12.5	0.50
1/2"	11.0	0.43	13.5	0.5337	14.5	0.56
3/4"	12.5	0.50	14.0	0.5457	16.0	0.62
1"	14.5	0.58	17.5	0.6828	19.0	0.75
1 1/4"	17.0	0.67	18.0	0.7068	20.5	0.81
1 1/2"	18.0	0.70	18.5	0.7235	20.5	0.81
2"	19.0	0.75	19.0	0.7565	22.0	0.88
2 1/2"	23.5	0.93	29.0	1.138	27.0	1.06
3"	26.0	1.02	30.5	1.200	28.5	1.12
4"	27.5	1.09	33.0	1.300	32.0	1.25

Ø nominale del tubo Nominal pipe size	Ø esterno del tubo Outside diameter of pipe mm	Num. filetti per pollice Number of threads per inch	Passo Pitch of thread mm	Ø sul filetto esterno Pitch diameter at external thread end mm	Ø sul filetto interno Pitch diameter at internal thread end mm	Lunghezza effettiva del filetto Effective threads length mm	Lunghezza serraggio a mano Length of hand tightening mm	Incremento del diametro per giro Increase in diameter per thread mm	Lunghezza del serraggio alla chiave Length of wrench tightening mm
D	n	P	E0	E1	L2	L1	A		
1/8"	10.29	27	0.940	9.233	9.489	6.703	4.102	0.0586	6.9
1/4"	13.72	18	1.411	12.126	12.487	10.205	5.786	0.0881	10
3/8"	17.14	18	1.411	15.545	15.926	10.358	6.096	0.0881	10.3
1/2"	21.34	14	1.814	19.264	19.772	13.556	8.128	0.1132	13.6
3/4"	26.67	14	1.814	24.579	25.117	13.860	8.610	0.1132	14.1
1"	33.40	11 1/2	2.209	30.826	31.461	17.343	10.160	0.1379	16.8
1 1/4"	42.16	11 1/2	2.209	39.551	40.218	17.952	10.668	0.1379	17.3
1 1/2"	48.26	11 1/2	2.209	45.621	46.287	18.377	10.668	0.1379	17.3
2"	60.32	11 1/2	2.209	57.633	58.325	19.215	11.074	0.1379	17.7
2 1/2"	73.02	8	3.175	69.076	70.159	28.892	17.322	0.1983	23.7
3"	88.90	8	3.175	84.852	86.068	30.480	19.456	0.1983	25.8
3 1/2"	101.60	8	3.175	97.472	98.776	31.750	20.853	0.1983	27.2
4"	114.30	8	3.175	110.093	111.433	33.020	21.437	0.1983	27.8

Ø nominale del tubo Nominal pipe size inches	Ø esterno del tubo Outside diameter of pipe inches	Num. filetti per pollice Number of threads per inch	Passo Pitch of thread inches	Ø sul filetto esterno Pitch diameter at external thread end inches	Ø sul filetto interno Pitch diameter at internal thread end inches	Lunghezza effettiva del filetto Effective threads length inches	Lunghezza serraggio a mano Length of hand tightening inches	Incremento del diametro per giro Increase in diameter per thread inches	Lunghezza del serraggio alla chiave Length of wrench tightening inches
D	n	P	E0	E1	L2	L1	A		
1/8"	0.405	27	0.03704	0.36351	0.37360	0.2639	0.1615	0.00231	0.2726
1/4"	0.540	18	0.05556	0.47739	0.49163	0.4018	0.2278	0.00347	0.3945
3/8"	0.675	18	0.05556	0.61201	0.62701	0.4078	0.240	0.00347	0.4067
1/2"	0.840	14	0.07143	0.75843	0.77843	0.5337	0.320	0.00446	0.5343
3/4"	1.050	14	0.07143	0.96768	0.98887	0.5457	0.339	0.00446	0.5533
1"	1.315	11 1/2	0.08696	1.21363	1.23863	0.6828	0.400	0.00543	0.6609
1 1/4"	1.660	11 1/2	0.08696	1.55713	1.58338	0.7068	0.420	0.00543	0.6809
1 1/2"	1.900	11 1/2	0.08696	1.79609	1.82234	0.7235	0.420	0.00543	0.6809
2"	2.375	11 1/2	0.08696	2.26902	2.29627	0.7565	0.436	0.00543	0.6969
2 1/2"	2.875	8	0.12500	2.71953	2.76216	1.1375	0.682	0.00781	0.9320
3"	3.500	8	0.12500	3.34062	3.38850	1.2000	0.766	0.00781	1.016
3 1/2"	4.000	8	0.12500	3.83750	3.88881	1.2500	0.821	0.00781	1.071
4"	4.500	8	0.12500	4.33438	4.33438	1.3000	0.844	0.00781	1.094

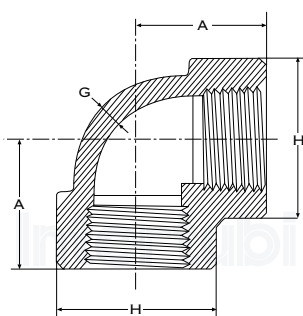

GOMITI 90°

ANSI B16.11
3000 - 6000 LBS

90° ELBOWS

ANSI B16.11
3000 - 6000 LBS

Diam. nominale Nominal pipe size	3000						6000					
	A		H		G		A		H		G	
	mm	inches	mm	inches	mm	inches	mm	inches	mm	inches	mm	inches
1/4"	25	0.97	25	1.00	3.5	0.130	29	1.12	33	1.31	6.5	0.260
3/8"	29	1.12	33	1.31	3.5	0.138	33	1.31	38	1.50	7.0	0.275
1/2"	33	1.31	38	1.50	4.0	0.161	38	1.50	46	1.81	8.0	0.321
3/4"	38	1.50	46	1.81	4.5	0.170	44	1.75	56	2.19	8.5	0.336
1"	44	1.75	56	2.19	5.0	0.196	51	2.00	62	2.44	10.0	0.391
1 1/4"	51	2.00	62	2.44	5.5	0.208	60	2.38	75	2.97	10.5	0.417
1 1/2"	60	2.38	75	2.97	5.5	0.219	64	2.50	84	3.31	11.0	0.436
2"	64	2.50	84	3.31	7.0	0.281	83	3.25	102	4.00	12.0	0.476
2 1/2"	83	3.25	102	4.00	7.5	0.301	95	3.75	121	4.75	15.5	0.602
3"	95	3.75	121	4.75	9.0	0.348	106	4.19	146	5.75	16.0	0.655
4"	114	4.50	152	6.00	11.00	0.440	114	4.50	152	6.00	18.5	0.735

Filettatura conforme a ANSI B 1.20.1 – Thread according to ANSI B 1.20.1

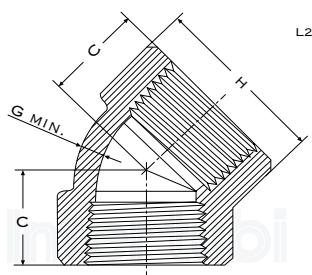

GOMITI 45°

ANSI B16.11
3000 - 6000 LBS

45° ELBOWS

ANSI B16.11
3000 - 6000 LBS

Diam. nominale Nominal pipe size	3000						6000					
	C		H		G		C		H		G	
	mm	inches	mm	inches	mm	inches	mm	inches	mm	inches	mm	inches
1/4"	19	0.75	25	1.00	3.5	0.130	22	0.88	33	1.31	6.5	0.260
3/8"	22	0.88	33	1.31	3.5	0.138	25	1.00	38	1.50	7.0	0.275
1/2"	25	1.00	38	1.50	4.0	0.161	29	1.12	46	1.81	8.0	0.321
3/4"	29	1.12	46	1.81	4.5	0.170	33	1.31	56	2.19	8.5	0.336
1"	33	1.31	56	2.19	5.0	0.196	35	1.38	62	2.44	10.0	0.391
1 1/4"	35	1.38	62	2.44	5.5	0.208	43	1.69	75	2.97	10.5	0.417
1 1/2"	43	1.69	75	2.97	5.5	0.219	44	1.72	84	3.31	11.0	0.436
2"	45	1.72	84	3.31	7.0	0.281	52	2.06	102	4.00	12.0	0.476
2 1/2"	52	2.06	102	4.00	7.5	0.301	64	2.50	121	4.75	15.5	0.602
3"	64	2.50	121	4.75	9.0	0.348	79	3.12	146	5.75	16.5	0.655
4"	79	3.12	152	6.00	11.00	0.440	79	3.12	152	6.00	18.5	0.735

Filettatura conforme a ANSI B 1.20.1 – Thread according to ANSI B 1.20.1

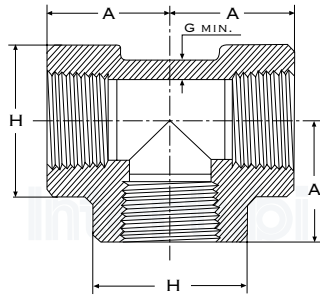

TEES

ANSI B16.11
3000 - 6000 LBS

TEES

ANSI B16.11
3000 - 6000 LBS

Diam. nominale Nominal pipe size	3000						6000					
	A		H		G		A		H		G	
	mm	inches	mm	inches	mm	inches	mm	inches	mm	inches	mm	inches
1/4"	25	0.97	25	1.00	3.5	0.130	29	1.12	33	1.31	6.5	0.260
3/8"	29	1.12	33	1.31	3.5	0.138	33	1.31	38	1.50	7.0	0.275
1/2"	33	1.31	38	1.50	4.0	0.161	38	1.50	46	1.81	8.0	0.321
3/4"	38	1.50	46	1.81	4.5	0.170	44	1.75	56	2.19	8.5	0.336
1"	44	1.375	56	2.19	5.0	0.196	51	2.00	62	2.44	10.0	0.391
1 1/4"	51	2.00	62	2.44	5.5	0.208	60	2.38	75	2.97	10.5	0.417
1 1/2"	60	2.38	75	2.97	5.5	0.219	64	2.50	84	3.31	11.0	0.436
2"	64	2.50	84	3.31	7.0	0.281	83	3.25	102	4.00	12.0	0.476
2 1/2"	83	3.25	102	4.00	7.5	0.301	95	3.75	121	4.75	15.5	0.602
3"	95	3.75	121	4.75	9.0	0.348	106	4.19	146	5.75	16.0	0.655
4"	114	4.50	152	6.00	11.00	0.440	114	4.50	152	6.00	18.5	0.735

Filettatura conforme a ANSI B 1.20.1 – Thread according to ANSI B 1.20.1

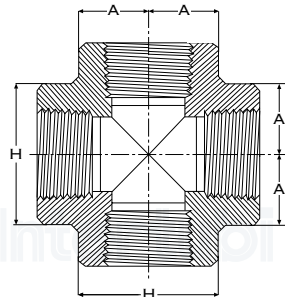

CROCI

ANSI B16.11
3000 - 6000 LBS

CROSSES

ANSI B16.11
3000 - 6000 LBS

Diam. nominale Nominal pipe size	3000						6000					
	A		H		G		A		H		G	
	mm	inches	mm	inches	mm	inches	mm	inches	mm	inches	mm	inches
1/4"	25	0.97	25	1.00	3.5	0.130	29	1.12	33	1.31	6.5	0.260
3/8"	29	1.12	33	1.31	3.5	0.138	33	1.31	38	1.50	7.0	0.275
1/2"	33	1.31	38	1.50	4.0	0.161	38	1.50	46	1.81	8.0	0.321
3/4"	38	1.50	46	1.81	4.5	0.170	44	1.75	56	2.19	8.5	0.336
1"	44	1.375	56	2.19	5.0	0.196	51	2.00	62	2.44	10.0	0.391
1 1/4"	51	2.00	62	2.44	5.5	0.208	60	2.38	75	2.97	10.5	0.417
1 1/2"	60	2.38	75	2.97	5.5	0.219	64	2.50	84	3.31	11.0	0.436
2"	64	2.50	84	3.31	7.0	0.281	83	3.25	102	4.00	12.0	0.476
2 1/2"	83	3.25	102	4.00	7.5	0.301	95	3.75	121	4.75	15.5	0.602
3"	95	3.75	121	4.75	9.0	0.348	106	4.19	146	5.75	16.0	0.655
4"	114	4.50	152	6.00	11.00	0.440	114	4.50	152	6.00	18.5	0.735

Filettatura conforme a ANSI B 1.20.1 – Thread according to ANSI B 1.20.1

Nota: i dati tecnici su questo catalogo sono indicativi e non impegnativi / Note: the technical data reported in this catalogue is proximate and not binding.
Data di emissione: 2014 Revisione: 01 / Date of issue: 2014 Revision: 01

Copyright © Intertubi S.p.a. Tutti i diritti sono riservati / Copyright © Intertubi S.p.a. All rights reserved

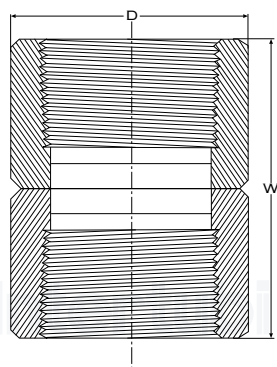

MANICOTTI

ANSI B16.11
3000 - 6000 LBS

COUPLINGS

ANSI B16.11
3000 - 6000 LBS

Diam. nominale Nominal pipe size	3000				6000			
	W		D		W		D	
	mm	inches	mm	inches	mm	inches	mm	inches
1/4"	35	1.38	19	0.75	35	1.38	25	1.00
3/8"	38	1.50	22	0.88	38	1.50	32	1.25
1/2"	48	1.88	29	1.12	48	1.88	38	1.50
3/4"	51	2.00	35	1.38	51	2.00	44	1.75
1"	60	2.38	44	1.75	60	2.38	57	2.25
1 1/4"	67	2.62	57	2.25	67	2.62	64	2.50
1 1/2"	79	3.12	64	2.50	79	3.12	76	3.00
2"	86	3.38	76	3.00	86	3.38	92	3.62
2 1/2"	92	3.62	92	3.62	92	3.62	108	4.25
3"	108	4.25	108	4.25	108	4.25	127	5.00
4"	121	4.75	140	5.50	121	4.75	159	6.25

Filettatura conforme a ANSI B 1.20.1 – Thread according to ANSI B 1.20.1

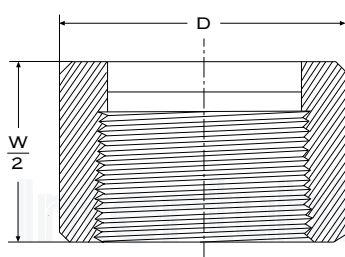

MEZZI MANICOTTI

ANSI B16.11
3000 - 6000 LBS

HALF-COUPLINGS

ANSI B16.11
3000 - 6000 LBS

Diam. nominale Nominal pipe size	3000				6000			
	W		D		W		D	
	mm	inches	mm	inches	mm	inches	mm	inches
1/4"	35	1.38	19	0.75	35	1.38	25	1.00
3/8"	38	1.50	22	0.88	38	1.50	32	1.25
1/2"	48	1.88	29	1.12	48	1.88	38	1.50
3/4"	51	2.00	35	1.38	51	2.00	44	1.75
1"	60	2.38	44	1.75	60	2.38	57	2.25
1 1/4"	67	2.62	57	2.25	67	2.62	64	2.50
1 1/2"	79	3.12	64	2.50	79	3.12	76	3.00
2"	86	3.38	76	3.00	86	3.38	92	3.62
2 1/2"	92	3.62	92	3.62	92	3.62	108	4.25
3"	108	4.25	108	4.25	108	4.25	127	5.00
4"	121	4.75	140	5.50	121	4.75	159	6.25

Filettatura conforme a ANSI B 1.20.1 – Thread according to ANSI B 1.20.1

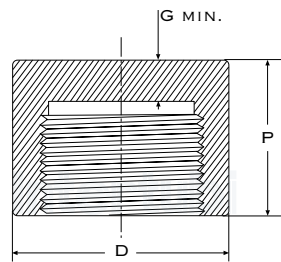

TAPPO FEMMINA

ANSI B16.11
3000 - 6000 LBS

CAPS

ANSI B16.11
3000 - 6000 LBS

Diam. nominale Nominal pipe size	3000						6000					
	P		D		G		P		D		G	
	mm	inches	mm	inches	mm	inches	mm	inches	mm	inches	mm	inches
1/4"	25	1.00	19	0.75	5.0	0.19	27	1.06	25	1.00	6.5	0.25
3/8"	25	1.00	22	0.88	5.0	0.19	27	1.06	32	1.25	6.5	0.25
1/2"	32	1.25	29	1.12	6.5	0.25	33	1.31	38	1.50	8.0	0.31
3/4"	37	1.44	35	1.38	6.5	0.25	38	1.50	44	1.75	8.0	0.31
1"	41	1.62	44	1.75	9.5	0.38	43	1.69	57	2.25	11.0	0.44
1 1/4"	44	1.75	57	2.25	9.5	0.38	46	1.81	64	2.50	11.0	0.44
1 1/2"	44	1.75	64	2.50	11.0	0.44	48	1.88	76	3.00	12.5	0.50
2"	48	1.88	76	3.00	12.5	0.50	51	2.00	92	3.62	16.0	0.62
2 1/2"	60	2.38	92	3.62	16.0	0.62	64	2.50	108	4.25	19.0	0.75
3"	65	2.56	108	4.25	19.0	0.75	68	2.69	127	5.00	22.0	0.88
4"	68	2.69	140	5.50	22.0	0.88	75	2.94	159	6.25	28.5	1.12

Filettatura conforme a ANSI B 1.20.1 – Thread according to ANSI B 1.20.1

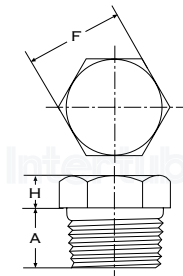

TAPPO MASCHIO - TESTA ESAGONALE

ANSI B16.11
3000 - 6000 LBS

HEXAGON HEAD PLUGS

ANSI B16.11
3000 - 6000 LBS

Diam. nominale Nominal pipe size	3000 - 6000					
	A min.		F nominal		H min.	
	mm	inches	mm	inches	mm	inches
1/4"	11	0.44	16.0	0.62	6	0.25
3/8"	12.5	0.50	17.5	0.69	8	0.31
1/2"	14.5	0.56	22.0	0.88	8	0.31
3/4"	16.0	0.62	27.0	1.06	10	0.38
1"	19.0	0.75	35.0	1.38	10	0.38
1 1/4"	20.5	0.81	44.5	1.75	14	0.56
1 1/2"	20.5	0.81	51.0	2.00	16	0.62
2"	22.0	0.88	63.5	2.50	17	0.69
2 1/2"	27.0	1.06	76.0	3.00	19	0.75
3"	28.5	1.12	89.0	3.50	21	0.81
4"	32.0	1.25	117.5	4.62	25	1.00

Filettatura conforme a ANSI B 1.20.1 – Thread according to ANSI B 1.20.1

Nota: i dati tecnici su questo catalogo sono indicativi e non impegnativi / Note: the technical data reported in this catalogue is proximate and not binding.
Data di emissione: 2014 Revisione: 01 / Date of issue: 2014 Revision: 01

Copyright © Intertubi S.p.a. Tutti i diritti sono riservati / Copyright © Intertubi S.p.a. All rights reserved

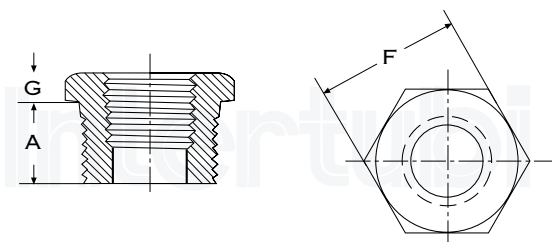

RIDUZIONI MASCHIO-FEMMINA

ANSI B16.11
3000 - 6000 LBS

HEX HEAD BUSHING

ANSI B16.11
3000 - 6000 LBS

Diam. nominale Nominal pipe size	3000 - 6000					
	A min.		F nominal		G min.	
	mm	inches	mm	inches	mm	inches
3/8" x 1/4"	12.5	0.50	17.5	0.69	7	0.16
1/2" x 3/8"	14.5	0.56	22.0	0.88	5	0.19
1/2" x 1/4"	14.5	0.56	22.0	0.88	5	0.19
3/4" x 1/2"	16.0	0.62	27.0	1.06	6	0.22
3/4" x 1/4"	16.0	0.62	27.0	1.06	6	0.22
1" x 3/4"	19.0	0.75	35.0	1.38	6	0.25
1" x 1/2"	19.0	0.75	35.0	1.38	6	0.25
1" x 1/4"	19.0	0.75	35.0	1.38	6	0.25
1 1/4" x 1"	20.5	0.81	44.5	1.75	7	0.28
1 1/2" x 1"	20.5	0.81	51.0	2.00	8	0.31
1 1/2" x 3/4"	20.5	0.81	51.0	2.00	8	0.31
1 1/2" x 1/2"	20.5	0.81	51.0	2.00	8	0.31
2" x 1 1/2"	22.0	0.88	63.5	2.50	9	0.34
2" x 1"	22.0	0.88	63.5	2.50	9	0.34
2 1/2" x 2"	27.0	1.06	76.0	3.00	10	0.38
3" x 2"	28.5	1.12	89.0	3.50	10	0.41
4" x 3"	32.0	1.25	117.5	4.62	13	0.50
4" x 2"	32.0	1.25	117.5	4.62	13	0.50

Filettatura conforme a ANSI B 1.20.1 – Thread according to ANSI B 1.20.1

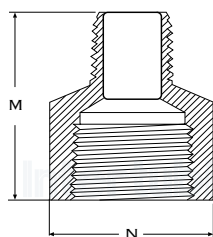

RIDUZIONI FEMMINA-MASCHIO

ANSI B16.11
3000 LBS

FEMALE-MALE REDUCERS

ANSI B16.11
3000 LBS

Diam. nominale Nominal pipe size	3000			
	M (1)		N (1)	
	mm	inches	mm	inches
3/8" x 1/4"	42	1.50	22	0.87
1/2" x 3/8"	49	1.81	28	1.10
1/2" x 1/4"	49	1.81	28	1.10
3/4" x 1/2"	59	2.01	35	1.38
1" x 3/4"	63	2.36	45	1.77
1" x 1/2"	61	2.36	45	1.77
1" x 1/4"	60	2.36	45	1.77
1 1/4" x 1"	68	2.68	60	2.24
1 1/2" x 1"	72	2.76	65	2.56
1 1/2" x 3/4"	67	2.76	65	2.56
1 1/2" x 1/2"	67	2.76	65	2.56
2" x 1/2"	70	2.95	76	2.99
2" x 1"	75	2.95	76	2.99
2 1/2" x 2"	92	3.74	95	3.74
3" x 2"	95	3.94	110	4.33
4" x 3"	113	4.33	140	5.51
4" x 2"	100	4.33	140	5.51

(1) Le dimensioni non elencate nell'ANSI B 16.11-1980 e BS 3799-1974 possono variare a seconda del produttore.
Dimensions not listed in ANSI B 16.11-1980 and BS 3799-1974 may vary according to the manufacturer.

Filettatura conforme a ANSI B 1.20.1 – Thread according to ANSI B 1.20.1

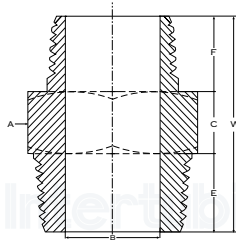

NIPPLI RIDOTTI

ANSI B16.11
3000 - 6000 LBS

REDUCING HEXAGONAL NIPPLES

ANSI B16.11
3000 - 6000 LBS

Diam. nominale Nominal pipe size		A (mini)		E (mini)		F (mini)		C (mini)		W (mini)		b*			
inches	mm	mm	inches	mm	inches	mm	inches	mm	inches	mm	inches	3000		6000	
												mm	inches	mm	inches
1/4" x 1/8"	8 x 6	15	0.59	15	0.59	10	0.39	6	0.24	31	1.22	5	0.20	2	0.08
3/8" x 1/4"	10 x 8	18	0.71	16	0.63	15	0.59	8	0.31	39	1.54	8	0.31	6	0.24
1/2" x 3/8"	15 x 10	22	0.87	20	0.79	16	0.63	8	0.31	44	1.73	11	0.43	8	0.31
1/2" x 1/4"	15 x 8	22	0.87	20	0.79	15	0.59	8	0.31	43	1.69	8	0.31	6	0.24
3/4" x 1/2"	20 x 15	27	1.06	21	0.83	20	0.79	9	0.35	50	1.97	14	0.55	11	0.43
3/4" x 3/8"	20 x 10	27	1.06	21	0.83	16	0.63	9	0.35	46	1.81	11	0.43	8	0.31
1" x 3/4"	25 x 20	35	1.38	25	0.98	21	0.83	10	0.39	56	2.20	19	0.75	13	0.51
1" x 1/2"	25 x 15	35	1.38	25	0.98	20	0.79	10	0.39	55	2.17	14	0.55	11	0.43
1 1/2" x 1"	40 x 25	50	1.97	26	1.02	25	0.98	16	0.63	67	2.64	24	0.94	17	0.67
1 1/2" x 3/4"	40 x 20	50	1.97	26	1.02	21	0.83	16	0.63	63	2.48	19	0.75	13	0.51
1 1/2" x 1/2"	40 x 15	50	1.97	26	1.02	20	0.79	16	0.63	62	2.44	14	0.55	11	0.43
2" x 1 1/2"	50 x 40	62	2.44	27	1.06	26	1.02	17	0.67	70	2.76	38	1.50	30	1.18
2" x 1"	50 x 25	62	2.44	27	1.06	25	0.98	18	0.71	70	2.76	24	0.94	17	0.67
2" x 3/4"	50 x 20	62	2.44	27	1.06	21	0.83	17	0.67	65	2.60	19	0.75	13	0.51
2" x 1/2"	50 x 15	62	2.44	27	1.06	20	0.79	18	0.71	65	2.60	14	0.55	11	0.43

(*) La dimensione «b» è nominale e soggetta alle normali tolleranze di fabbricazione.
Dimension «b» is nominal and is subject to normal MANUFACTURE tolerances.

Filettatura conforme a ANSI B 1.20.1 – Thread according to ANSI B 1.20.1

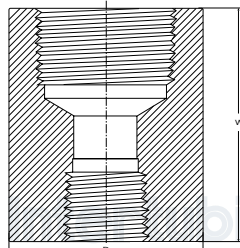

MANICOTTO RIDOTTO

ANSI B16.11
3000 - 6000 LBS

REDUCING COUPLING

ANSI B16.11
3000 - 6000 LBS

Diam. nominale Nominal pipe size	3000				6000			
	W ⁽¹⁾		D ⁽¹⁾		W ⁽¹⁾		D ⁽¹⁾	
	mm	inches	mm	inches	mm	inches	mm	inches
3/8" x 1/4"	38.10	1.50	22.35	0.88	38.10	1.50	31.75	1.25
1/2" x 3/8"	47.75	1.88	28.45	1.12	47.75	1.88	38.10	1.50
1/2" x 1/4"	47.75	1.88	28.45	1.12	47.75	1.88	38.10	1.50
3/4" x 1/2"	50.80	2.00	35.05	1.38	50.80	2.00	44.45	1.75
3/4" x 1/4"	50.80	2.00	35.05	1.38	50.80	2.00	44.45	1.75
1" x 3/4"	60.45	2.38	44.45	1.75	60.45	2.38	57.15	2.25
1" x 1/2"	60.45	2.38	44.45	1.75	60.45	2.38	57.15	2.25
1" x 1/4"	60.45	2.38	44.45	1.75	60.45	2.38	57.15	2.25
1 1/4" x 1"	66.55	2.62	57.15	2.25	66.55	2.62	63.50	2.50
1 1/2" x 1"	79.25	3.12	63.50	2.50	79.25	3.12	76.20	3.00
1 1/2" x 3/4"	79.25	3.12	63.50	2.50	79.25	3.12	76.20	3.00
1 1/2" x 1/2"	79.25	3.12	63.50	2.50	79.25	3.12	76.20	3.00
2" x 1 1/2"	85.85	3.38	76.20	3.00	85.85	3.38	91.95	3.62
2" x 1"	85.85	3.38	76.20	3.00	85.85	3.38	91.95	3.62
2 1/2" x 2"	91.95	3.62	91.95	3.62	90.95	3.62	107.95	4.25
3" x 2"	107.95	4.25	107.95	4.25	107.95	4.25	127.00	5.00
4" x 3"	120.65	4.75	139.70	5.50	120.65	4.75	158.75	6.25
4" x 2"	120.65	4.75	139.70	5.50	120.65	4.75	158.75	6.25

⁽¹⁾ Le dimensioni non elencate nell'ANSI B 16.11-1980 e BS 3799-1974 possono variare a seconda del produttore.
Dimensions not listed in ANSI B 16.11-1980 and BS 3799-1974 may vary according to the manufacturer.

Note: i dati tecnici su questo catalogo sono indicativi e non impegnativi / Note: the technical data reported in this catalogue is proximate and not binding.
Data di emissione: 2014 Revisione: 01 / Date of issue: 2014 Revision: 01

Copyright © Intertubi S.p.a. Tutti i diritti sono riservati / Copyright © Intertubi S.p.a. All rights reserved

NIPPO
ANSI B16.11
3000 - 6000 LBS

HEXAGONAL NIPPLES
ANSI B16.11
3000 - 6000 LBS

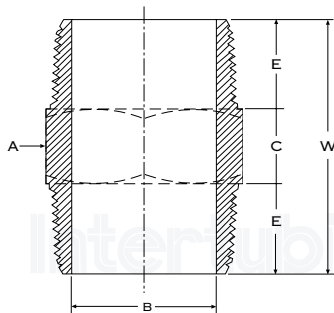

Diam. nominale Nominal pipe size		A (mini)		E (mini)		C (mini)		W (mini)		b*			
inches	mm	mm	inches	mm	inches	mm	inches	mm	inches	3000		6000	
										mm	inches	mm	inches
1/8"	6	11	0.43	10	0.39	6	0.24	26	1.02	5	0.20	2	0.08
1/4"	8	15	0.59	15	0.59	6	0.24	36	1.42	8	0.31	6	0.24
3/8"	10	18	0.71	16	0.63	8	0.31	40	1.57	11	0.43	8	0.31
1/2"	15	22	0.87	20	0.79	8	0.31	48	1.89	14	0.55	11	0.43
3/4"	20	27	1.06	21	0.83	10	0.39	52	2.05	19	0.75	13	0.51
1"	25	35	1.38	25	0.98	10	0.39	60	2.36	24	0.94	17	0.67
1 1/2"	40	50	1.97	26	1.02	16	0.63	68	2.68	38	1.50	30	1.18
2"	50	62	2.44	27	1.06	17	0.67	71	2.80	49	1.93	39	1.54

(*) La dimensione «b» è nominale e soggetta alle normali tolleranze di fabbricazione.
Dimension «b» is nominal and is subject to normal MANUFACTURE tolerances.

Filettatura conforme a ANSI B 1.20.1 – Thread according to ANSI B 1.20.1

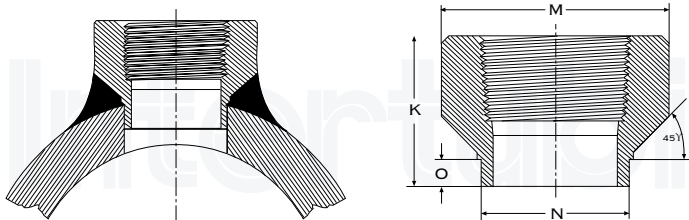

DERIVAZIONE FILETTATA
3000 - 6000 LBS

THREADED OUTLET
3000 - 6000 LBS

Diam. nominale Nominal pipe size	3000 – 6000					
	K ⁽¹⁾		M ⁽¹⁾		N ⁽¹⁾	
	mm	inches	mm	inches	mm	inches
1/4"	30.5	1.20	28.0	1.10	14.0	0.55
3/8"	30.5	1.20	32.0	1.26	17.4	0.69
1/2"	33.5	1.32	38.0	1.50	21.6	0.85
3/4"	35.0	1.38	44.5	1.75	26.9	1.06
1"	43.0	1.69	57.5	2.26	33.6	1.32
1 1/4"	48.0	1.89	63.5	2.50	42.4	1.67
1 1/2"	51.0	2.00	76.1	3.00	48.5	1.91
2"	57.5	2.26	92.0	3.62	60.9	2.40

⁽¹⁾ Le dimensioni non elencate nell'ANSI B 16.11-1980 e BS 3799-1974 possono variare a seconda del produttore.
Dimensions not listed in ANSI B 16.11-1980 and BS 3799-1974 may vary according to the manufacturer.

DA 1/4" A 2' O = 9,5 mm
FROM 1/4" TO 2' O = 0,375 inch

Filettatura conforme a ANSI B 1.20.1 – Thread according to ANSI B 1.20.1

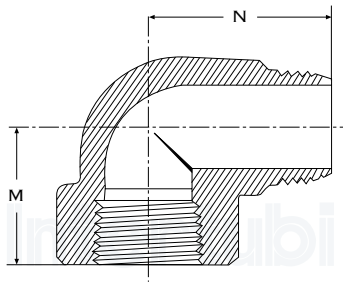

GOMITI MASCHIO-FEMMINA A 90°

ANSI B16.11
3000 - 6000 LBS

90° STREET ELBOWS

ANSI B16.11
3000 - 6000 LBS

Diam. nominale Nominal pipe size	3000				6000			
	M ⁽¹⁾		N ⁽¹⁾		M ⁽¹⁾		N ⁽¹⁾	
	mm	inches	mm	inches	mm	inches	mm	inches
1/4"	24.6	0.97	32.0	1.05	30.0	1.12	39.0	1.26
3/8"	30.0	1.12	39.0	1.26	33.5	1.31	44.0	1.39
1/2"	33.5	1.31	44.0	1.39	38.0	1.50	49.0	1.61
3/4"	38.0	1.50	49.0	1.61	46.5	1.75	59.0	1.97
1"	46.5	1.75	59.0	1.97	53.0	2.00	65.0	2.40
1 1/4"	53.0	2.00	65.0	2.40	62.0	2.27	75.0	2.75
1 1/2"	62.0	2.27	75.0	2.75	68.0	2.50	82.5	3.25
2"	68.0	2.50	82.5	3.25	82.5	3.25	110.0	4.33

⁽¹⁾ Le dimensioni non elencate nell'ANSI B 16.11-1980 e BS 3799-1974 possono variare a seconda del produttore.
Dimensions not listed in ANSI B 16.11-1980 and BS 3799-1974 may vary according to the manufacturer.

Filettatura conforme a ANSI B 1.20.1 – Thread according to ANSI B 1.20.1

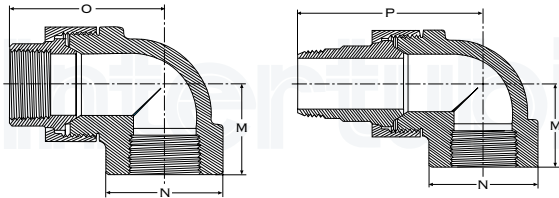

GOMITO TRE PEZZI

ANSI B16.11
3000 LBS

UNION ELBOWS

ANSI B16.11
3000 LBS

Diam. nominale Nominal pipe size		1/4"	3/8"	1/2"	3/4"	1"	1 1/4"	1 1/2"	2"
3000									
M ⁽¹⁾	mm	28.5	28.5	33	38	44.5	60.5	60.5	63.5
	inches	1.12	1.12	1.30	1.50	1.75	2.38	2.38	2.50
N ⁽¹⁾	mm	34	34	38	45.5	56.5	76	76	92
	inches	1.34	1.34	1.50	1.83	2.22	3.00	3.00	3.62
O ⁽¹⁾	mm	46.5	54	60	67	75	85	98	109
	inches	2.02	2.13	2.56	2.64	3.15	3.19	3.97	4.29
P ⁽¹⁾	mm	62	72	82	90	102	115	125	140
	inches	2.72	2.83	3.47	3.55	4.25	4.96	5.20	5.51

⁽¹⁾ Le dimensioni non elencate nell'ANSI B 16.11-1980 e BS 3799-1974 possono variare a seconda del produttore.
Dimensions not listed in ANSI B 16.11-1980 and BS 3799-1974 may vary according to the manufacturer.

Filettatura conforme a ANSI B 1.20.1 – Thread according to ANSI B 1.20.1

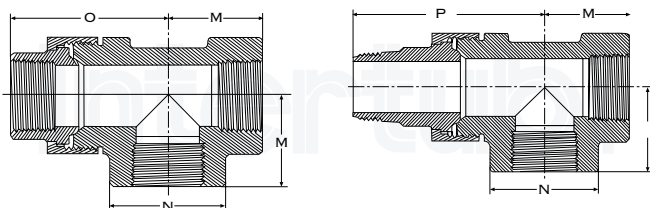

GIUNTO TRE PEZZI A T

ANSI B16.11
3000 LBS

UNION TEES

ANSI B16.11
3000 LBS

Diam. nominale Nominal pipe size		1/4"	3/8"	1/2"	3/4"	1"	1 1/4"	1 1/2"	2"
3000									
M ⁽¹⁾	mm	28.5	28.5	33	38	44.5	60.5	60.5	63.5
	inches	1.12	1.12	1.30	1.50	1.75	2.38	2.38	2.50
N ⁽¹⁾	mm	34	34	38	45.5	56.5	76	76	92
	inches	1.34	1.34	1.50	1.83	2.22	3.00	3.00	3.62
O ⁽¹⁾	mm	46.5	54	60	67	75	85	98	109
	inches	2.02	2.13	2.56	2.64	3.15	3.19	3.97	4.29
P ⁽¹⁾	mm	62	72	82	90	102	115	125	140
	inches	2.72	2.83	3.47	3.55	4.25	4.96	5.20	5.51

⁽¹⁾ Le dimensioni non elencate nell'ANSI B 16.11-1980 e BS 3799-1974 possono variare a seconda del produttore.
Dimensions not listed in ANSI B 16.11-1980 and BS 3799-1974 may vary according to the manufacturer.

Filettatura conforme a ANSI B 1.20.1 – Thread according to ANSI B 1.20.1

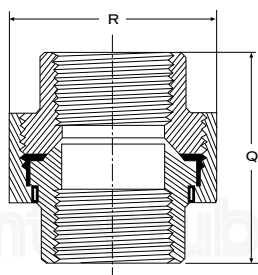

GIUNTO TRE PEZZI FEMMINA-FEMMINA

ANSI B16.11
3000 - 6000 LBS

FEMALE-FEMALE UNIONS

ANSI B16.11
3000 - 6000 LBS

Diam. nominale ND	3000				6000			
	Q ⁽¹⁾		R ⁽¹⁾		Q ⁽¹⁾		R ⁽¹⁾	
	mm	inches	mm	inches	mm	inches	mm	inches
1/4"	42.5	1.67	36.0	1.42	54.0	2.13	46.0	1.81
3/8"	47.5	1.87	41.0	1.62	57.0	2.25	51.0	2.00
1/2"	52.0	2.05	46.0	1.81	69.0	2.72	60.0	2.36
3/4"	57.0	2.25	56.0	2.20	72.0	2.84	72.0	2.84
1"	63.0	2.48	65.0	2.56	80.0	3.15	80.0	3.15
1 1/4"	68.0	2.76	80.0	3.07	89.0	3.50	94.0	3.70
1 1/2"	78.0	3.07	88.0	3.39	108.0	4.25	100.0	3.94
2"	91.0	3.50	105.0	4.06	114.0	4.49	122.0	4.80
2 1/2"	120.0	4.49	122.0	4.80	130.0	5.13	144.0	5.67
3"	140.0	5.12	144.0	5.67	150.0	5.91	180.0	7.09
4"	148.0	5.91	200.0	7.09				

⁽¹⁾ Le dimensioni non elencate nell'ANSI B 16.11-1980 e BS 3799-1974 possono variare a seconda del produttore.
Dimensions not listed in ANSI B 16.11-1980 and BS 3799-1974 may vary according to the manufacturer.

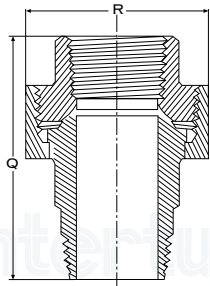

GIUNTO TRE PEZZI MASCHIO-FEMMINA

ANSI B16.11
3000 - 6000 LBS

MALE-FEMALE UNIONS

ANSI B16.11
3000 - 6000 LBS

Diam. nominale Nominal pipe size	3000				6000			
	Q ⁽¹⁾		R ⁽¹⁾		Q ⁽¹⁾		R ⁽¹⁾	
	mm	inches	mm	inches	mm	inches	mm	inches
1/4"	61.0	2.48	32.0	1.26	82.5	2.86	46.0	1.81
3/8"	69.0	2.72	38.0	1.50	77.0	3.03	51.0	2.00
1/2"	75.0	3.03	46.0	1.81	94.5	3.72	60.0	2.36
3/4"	80.0	3.15	56.0	2.00	98.5	3.88	72.0	2.84
1"	90.0	3.82	65.0	2.36	108.0	4.25	80.0	3.15
1 1/4"	98.0	3.98	80.0	2.84	120.0	4.72	94.0	3.70
1 1/2"	100.0	4.33	88.0	3.15	138.0	5.44	100.0	3.94
2"	120.0	4.72	105.0	3.70	146.0	5.75	122.0	4.80

⁽¹⁾ Le dimensioni non elencate nell'ANSI B 16.11-1980 e BS 3799-1974 possono variare a seconda del produttore.
Dimensions not listed in ANSI B 16.11-1980 and BS 3799-1974 may vary according to the manufacturer.

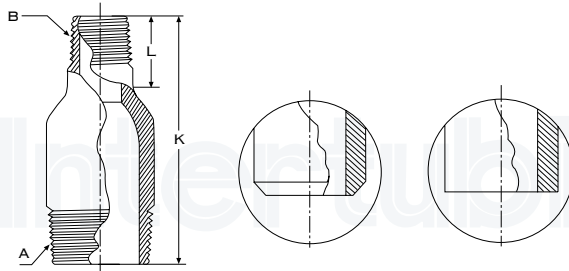

NIPPLI DA TUBO A BOTTIGLIA

3000 - 6000 LBS

SWAGE NIPPLES

3000 - 6000 LBS

Diam. nominale Nominal pipe size A x B	3000 - 6000				Spessore conforme a ANSI B 36-10-1985 Thickness according to ANSI B 36-10-1985		
	K ⁽¹⁾		L ⁽¹⁾				
	mm	inches	mm	inches			
3/8" x 1/4"	76	2.36	20	0.79	Sch 40	Sch 80	-
1/2" x 3/8"	89	2.36	20	0.79	Sch 40	Sch 80	-
1/2" x 1/4"	89	2.36	20	0.79	Sch 40	Sch 80	-
3/4" x 1/2"	95	2.75	21	0.83	Sch 40	Sch 80	Sch 160
3/4" x 1/4"	95	2.75	21	0.83	Sch 40	Sch 80	-
1" x 3/4"	102	3.55	22	0.87	Sch 40	Sch 80	Sch 160
1" x 1/2"	102	3.55	22	0.87	Sch 40	Sch 80	Sch 160
1" x 1/4"	102	3.55	25	0.98	Sch 40	Sch 80	Sch 160
1 1/4" x 1"	114	4.53	25	0.98	Sch 40	Sch 80	Sch 160
1 1/2" x 1"	114	4.53	25	0.98	Sch 40	Sch 80	Sch 160
1 1/2" x 3/4"	114	4.53	25	0.98	Sch 40	Sch 80	Sch 160
1 1/2" x 1/2"	165	6.50	30	1.18	Sch 40	Sch 80	Sch 160
2" x 1 1/2"	165	6.50	30	1.18	Sch 40	Sch 80	Sch 160
2" x 1"	165	6.50	30	1.18	Sch 40	Sch 80	Sch 160
2 1/2" x 2"	178	7.01	35	1.38	Sch 40	Sch 80	Sch 160
3" x 2"	203	8.00	40	1.57	Sch 40	Sch 80	Sch 160
4" x 3"	229	9.06	45	1.77	Sch 40	Sch 80	Sch 160
4" x 2"	229	9.06	45	1.77	Sch 40	Sch 80	Sch 160

⁽¹⁾ Le dimensioni non elencate nell'ANSI B 16.11-1980 e BS 3799-1974 possono variare a seconda del produttore.
Dimensions not listed in ANSI B 16.11-1980 and BS 3799-1974 may vary according to the manufacturer.

Filettatura conforme a ANSI B 1.20.1 – Thread according to ANSI B 1.20.1

NOTE - NOTES:

Estremità a saldare secondo ANSI B 16.25 – Buttwelding ends according to ANSI B 16.25

Estremità filettate secondo ANSI B 1.20.1 – Thread ends according to ANSI B 1.20.1

Tolleranze su diametro e spessore secondo ASTM A 106 – Variations in outside diameter and thickness according to ASTM A 106

CODICI UTILIZZATI PER LA DESCRIZIONE DEGLI SWEDGE NIPPLES

(nippli ridotti)

P.B.E.	Due estremità lisce	
P.L.E.	Diametro maggiore liscio	
P.S.E.	Diametro inferiore liscio	
B.B.E.	Due estremità smussate	
B.L.E.	Diametro maggiore smussato	
B.S.E.	Diametro inferiore smussato	
T.B.E.	Due estremità filettate	
T.L.E.	Diametro maggiore filettato	
T.S.E.	Diametro inferiore filettato	
B.O.E.	Un'estremità smussata	si applicano solo ai nippli da tubo
P.O.E.	Un'estremità liscia	
T.O.E.	Un'estremità filettata	

Si possono utilizzare due codici per lo stesso pezzo. Esempio:

1 Swage Nipple 3 X 2 BLE/TSE

Dunque:

- DIAMETRO MAGGIORE SMUSSATO
- DIAMETRO MINORE FILETTATO

CODE USED IN MATERIAL LIST OF SWEDGE NIPPLES

(reduced nipples)

P.B.E.	Plain both ends	
P.L.E.	Plain large end	
P.S.E.	Plain small end	
B.B.E.	Beveled both ends	
B.L.E.	Beveled large end	
B.S.E.	Beveled small end	
T.B.E.	Threaded both ends	
T.L.E.	Threaded large end	
T.S.E.	Threaded small end	
B.O.E.	Beveled one end	for barrel nipples only
P.O.E.	Plain one end	
T.O.E.	Threaded one end	

Two codes may be used on the same item for example:

1 Swage Nipple 3 X 2 BLE/TSE

Which means:

- BEVELED LARGE END
- THREADED SMALL END

